

FILE - not to be removed

1904

Crystal Palace



PROGRAMME

GUY WHITTEN & CO CRYSTAL PALACE AND AT BATTERSEA

NOTICE

SEASON TICKETS.

Season Tickets will be issued at the following rates:—

TRANSFERABLE.

YEARLY. From the 1st of any month.

Admitting One Person £2 2/-

NON-TRANSFERABLE.

YEARLY. From the 1st of any month.

Adults £1 1/-

Children under 12 years of age 10/6

HALF-YEARLY. From 1st January to 30th June, and
1st July to 31st December

10/6

MONTHLY. From any day in month to corresponding date in following month.

Non-transferable Monthly Tickets 5/-

BOOKS OF ADMISSION TICKETS.—For the convenience of small Excursion Parties, and to meet the wishes of Season Ticket Holders for Tickets to hand to their friends and others, Book containing Twenty Transferable Admission Tickets for Shilling Days are issued on payment of Fifteen Shillings for Adults, and Seven Shillings and Sixpence for Children

TO LET

Special Arrangements To-day

1st Prize.—THE CHAMPIONSHIP OF GREAT BRITAIN AND THE COLONIES, the winners of which will be the holders for the year (under the conditions referred to in the Regulations) of the

NATIONAL CHALLENGE TROPHY of the Value of One Thousand Guineas,

with a Beautifully Illuminated Certificate for framing, and a **Cash Prize of £40.** Each Member of the Band, including Bandmaster and Secretary, will also be presented with the **CRYSTAL PALACE CHAMPIONSHIP BRONZE MEDAL**, with bar and clasp. [Members of Bands winning the Cup twice, will be presented with the same Medal in solid Silver; and for Members of Bands winning three times, a solid Gold Medal will be presented.]

Messrs. BOOSEY & Co., 295, Regent Street, London, W., will present to the First Prize Band, a plated, gilt, and engraved EUPHONION, with four patent compensating pistons, in leather case, value £31 10s.

Messrs. HODGSON & Co., Victoria Lane, Ramsden Street, Huddersfield, will also present to the First Prize Band, a set of 24 BAND CAPS, of whatever style or design the Band may choose. Value £10 10s.

Grand Total of First Prize, £1,142 10s.

2nd Prize—Magnificent CHALLENGE CUP, value 50 Guineas, presented by the Proprietors of the *London Daily Telegraph*, and **Cash £30.**

Messrs. HAWKES & SON, Denman Street, Piccadilly Circus, W., will present to the Second Prize Band a B-flat SLIDE TROMBONE, Excelsior Sonorous Class, fully embellished and fitted with improved water key, triply silver plated, handsomely engraved and gilt outside bell and gilded inside bell, fitted complete, with fine black enamel leather lock-up case, value £18 18s.

3rd Prize, Cash £20. Messrs. BESSON & Co., LTD., 196 and 198, Euston Road, London, N.W., will present to the Third Prize Band a B-flat "Proteano" CORNET, with Quick Change Slide from B-flat to A-natural—the change of key being effected without removing the instrument from the lips—richly engraved, gilt plated, complete in case, value £18 18s.

4th Prize, Cash £16. Messrs. RUDALL, CARTE, & Co., 23, Berners Street, Oxford Street, will present to the Fourth Prize Band one of their new patent Conical Bore CORNETS, richly plated, engraved, and gilt, in leather case, value £17 17s.

5th Prize, Cash £12. Messrs. GIBBORNE & Co., 14, Gray's Inn Road, London; and Apollo Works, Vere Street, Birmingham, will present to the Fifth Prize Band a celebrated Gisborne TROMBONE, Imperial Supreme Class, as used by the chief Trombone players in England; triply plated, engraved, in New Century case, plush lined, value £12 12s.

6th Prize, Cash £10. Messrs. JOSEPH HIGHAM, LTD., 127, Strangeways, Manchester, will present to the Sixth Prize Band a B-flat CORNET, "Patent Clear Bore, Class A," Rex model, silver plated, fitted with improved extra light valves, value £9 9s.

7th Prize, Cash £5. Mr. ALFRED HAYS, 26, Old Bond Street, London, W., will present to the Seventh Prize Band an E-flat TENOR HORN, "Buffet" workmanship and finish, electro plated and burnished in best manner, value £10 10s.

8th Prize.—Mr. JOHN BEEVER, Brook Street, Huddersfield, will present to the Eighth Band in order of merit a set of BAND CAPS, to be chosen from their stand, with patent floral or other pattern peaks, best indigo cloth, and trimmed to Band's own choice in design or colour, value £10 10s.

9th Prize.—Messrs. MALLETT, PORTER, & DOWD, LTD., Caledonian Road, London, N., will present to the Ninth Band in order of merit 24 New Pattern STAFF CAPS, with gold piping, black oakleaf bands, and real gold peaks, superior quality, value £10 10s.

10th Prize.—Messrs. CHAPPELL & Co., LTD., 50, New Bond Street, London, W., will present to the Tenth Band in order of merit 26 Volumes containing 20 Numbers of CHAPPELL'S BRASS BAND JOURNAL, bound in red cloth, with gilt lettering, value £10 10s.

GRAND SHIELD SECTION.

Test Piece ... "Polinto" (Donizetti) ... *arr. by E. Swift*

1st Prize—Magnificent CHALLENGE SHIELD, value 50 Guineas, presented by the Proprietors of the *London Daily Express*, and a Cash Prize of £20. **2nd**—Cash Prize, £10. **3rd**—Cash Prize, £5. **4th**—Cash Prize, £3. **5th**—Cash Prize, £2. **6th**—Cash Prize, £1 10s. **7th**—Cash Prize, £1. **8th, 9th, 10th, 11th, and 12th**—CERTIFICATES OF MERIT.

JUNIOR CUP SECTION.

Test Piece ... "Gems of Tschalkowsky" ... arr. by E. Swift

1st Prize—Magnificent CHALLENGE CUP, value 50 Guineas, presented by the Proprietors of the London Daily Graphic, and £5 in Cash. 2nd—Cash Prize, £3. 3rd—Cash Prize, £2. 4th—Cash Prize, £1.

PRELIMINARY SHIELD SECTION.

Test Pieces ... "Tschalkowsky" or "H.M.S. Pinafore" (Sir A. Sullivan)

1st Prize—The People CHALLENGE SHIELD, value 50 Guineas, presented by the Proprietors of The People weekly Newspaper, and £5. 2nd—Cash Prize, £3. 3rd—Cash Prize, £2. 4th—Cash Prize, £1.

PRELIMINARY CUP SECTION.

Test Piece ... "H.M.S. Pinafore" ... Sir A. Sullivan

1st Prize—The Champion Journal CHALLENGE CUP, value 10 Guineas, presented by R. SMITH & Co., Ltd., and £5 in Cash. 2nd—Cash Prize, £3. 3rd—Cash Prize, £2. 4th—Cash Prize, £1.

REED SECTION.

Test Piece ... "Gems of Scotch Melody" ... arr. by J. Ord Hume

1st Prize—The Pearson's Weekly CHALLENGE SHIELD, value 50 Guineas, and 1 "Giorgi" Patent CONCERT PICCOLO, in case complete, value 1 Guinea. 2nd—The "CRYSTAL PALACE" CHALLENGE CUP, value 10 Guineas, and 1 "Giorgi" Patent CONCERT PICCOLO, in case complete, value 1 Guinea. 3rd—A Millereau B-flat SOPRANO SAXOPHONE, presented by A. W. GILMER & Co., 32, Paradise Street, Birmingham, value £12 12s. 4th—A B-flat CLARINET, presented by the British Bandsman, value £5 5s. 5th—A Set of "Firmanlite" BAND STANDS for 30 Players, stained and polished walnut, value £5 5s., presented by Mr. A. RADCLIFFE, Friezland Works, Greenfield, Oldham.

BOYS' BAND CONTEST.

Open to all Boys' Bands, either Brass, or Brass and Reed. No Band to exceed 30 Players, who must not exceed 16 years of age.

Test Piece ... "Amicizia" ... W. Paris Chambers

1st Prize—The WOOD'S CHALLENGE CUP, presented by W S. Woods, Esq., of Sheffield, and FRAMED CERTIFICATE; and 1 "Giorgi" Patent CONCERT PICCOLO, in case complete, value 1 Guinea; and 6 Bound Volumes of the "BRITISH BANDSMAN."

2nd Prize—FRAMED CERTIFICATE, and 1 "Giorgi" Patent CONCERT FLUTE (by Messrs. Wallis & Son, Euston Road, N.W.), in case complete, value £2 2s., and 6 Bound Volumes of the "BRITISH BANDSMAN."

3rd Prize—FRAMED CERTIFICATE, and 1 "Giorgi" Patent CONCERT PICCOLO, in case complete, value 1 Guinea, and 6 Bound Volumes of the "BRITISH BANDSMAN."

4th Prize—FRAMED CERTIFICATE, and 2 Volumes of "BRITISH BANDSMAN."

GRAND TOTAL OF PRIZES:

Seventeen Hundred and Sixty-Five Pounds.

THE CRYSTAL PALACE COMPANY'S SCHOOL OF PRACTICAL ENGINEERING.

Principal - J. W. WILSON, M.Inst.C.E., M.Inst.Mech.E.

Vice-Principal MAURICE WILSON, A.M.Inst.C.E.

Assisted by a Staff of Eight Lecturers and Instructors, besides Lecturers on additional and special subjects.

Winter Term commenced on Wednesday, September 7th.

The School may be inspected during working hours on application to the Principal, and Prospectuses may be obtained at the School, Secretary's Office, General Manager's Office, and Library.

Programme.

SATURDAY,

OCTOBER 1st, 1904

Open To-day from 10.0 a.m. to 10.30 p.m. Admission is.

ALL EXIT GATES FROM THE GROUNDS CLOSE AT 11.0 P.M.

N.B.—The times and positions of the Bands in this Programme are subject to alteration on Wet Days.

ST. JOHN AMBULANCE DEPOT (South Nave, top of staircase leading to Grounds) marked 37 on Plan. Nurses and Members of the Upper Norwood Branch on duty.

LAST GRAND FIREWORK DISPLAY

All Day from 10.30 a.m.

The Director's Office will be at the "British Bandsman" Stand, outside Concert Hall

THE FIFTH GREAT NATIONAL BAND FESTIVAL

Under the direction of MR. J. HENRY ILES.

In connection with the above Festival, takes place

The Great Championship Contest for the Magnificent Challenge Trophy,
Value 1,000 Guineas.

This Trophy is made of solid gold and silver, and is beautifully chased and incrusting with valuable stones and gems. It cost the sum of One Thousand Guineas, which was paid by the Crystal Palace Company to the Makers, who stated when receiving payment, that this sum— although so large—did not cover the actual cost.

LIST OF WINNERS.

1900 ... Denton Original Prize Band.
1901 ... Lee Mount Prize Band.

1902 ... Black Dike Mills Prize Band.
1903 ... Besses o' th' Barn Prize Band.

Test Piece ... Grand Selection, "Mendelssohn" Lieut. Chas. Godfrey, M.V.O., R.A.M.

For Prizes, &c., see Next Page.

No Breakfast Table
complete without

EPPS'S

The Cream of Cocoas.

COCOA

The Most Nutritious
and Economical.

THE POPULAR
SCOTCH

IS
"BLACK & WHITE"

WHISKY.

All Day.

In Canadian Court (South Nave).

DOMINION OF CANADA PERMANENT EXHIBITS.

Handsome Exhibit of Artistic Canadian Furniture for House and Office (from 21 factories in Canada). Canadian Canoes and Boats.

Grocers should not miss seeing the Exhibition in this Court of Canadian Tinned Salmon.

ADMISSION FREE.

All Day.

Entrance near Library (North Nave).

MONKEY AND PARROT HOUSE AND AQUARIUM.

Specimens of Indian Fish lent by H.M. THE KING. Eighteen kinds of Fresh-Water Fish feed Daily at 4 p.m. *Free.*

All Day.

In the Caricature Salon, South Nave.

THE WEIRD AND SCREAMINGLY FUNNY

DISTORTING MIRRORS.

The Visitor sees himself distorted in all shapes and sizes, every Mirror showing a distinct distortion—from dwarf to giant—from skeleton to corpulency—with endless arms and legs. Some of the Mirrors twisting the body into several different shapes. This Entertainment is distinctly novel and original, and created a great sensation at the Paris Exhibition.

OPEN ALL DAY. No Waiting. Admission Threepence.

All Day.

In South Nave.

SEA TRIP THROUGH THE BAY OF NAPLES.

The Greatest Novelty in the Entertainment World.

A Marvellous Travelling Illusion, in which the Visitor sails on Board a Felucca through this magnificent Bay. Also Photo-Sculptural

Views of Pompell "As it Was and As it is."

Views taken on the spot by Signor Luzzati, giving a Representation of **The Eruption of Mount Vesuvius.**

Admission Threepence.

All Day.

In Egyptian Court (North Nave).

"GIANT WALTZING TOPS,"

THE LATEST NOVELTY!

Consisting of Six Enormous Tops, capable of carrying Six Passengers in each. The Tops spinning round in an opposite direction to the Revolving Platform.

A delightful Sensation!

Ride—Twopence each Passenger.

All Day.

In Electric Theatre.—**ANIMATED PICTURES.**

THE RUSSO-JAPANESE WAR

Sensational Star Pictures of the Great Struggle in the Far East.

Grand Realistic Series of Highly Interesting Animated Pictures
Thrilling Scenes and Incidents!

Admission Sixpence. Children Threepence.

All Day.

In Music Court (South Nave).

GRAND REALISTIC TABLEAU, DEPICTING

THE GREAT FIRE OF LONDON, 1666.

Reproduction of Old London at Midnight, when the Fire reached its climax of destruction. Everyone should see this sensational and realistic portrayal of the great national disaster. The spectator is carried back nearly two and-a-half centuries.

Viewing the City of Flames from an arch of Old London Bridge

Admission Sixpence.

Special Arrangements To-day

All Day. **SIR HIRAM MAXIM'S
CAPTIVE FLYING MACHINES**

THE SENSATION OF THE AGE!

Passenger Fare: Adults—SIXPENCE; Children—THREEPENCE.

At Intervals. **In Grounds** (Experiments Daily, weather and circumstances permitting).

CODY'S KITES

Including the identical **War Kites**, lately experimented with at Aldershot before the Military Authorities.

All Day.

On the Great Lake (bottom of Grounds).

BOATING and ROWING.

Hire of Boats: One Person, per hour, 1/-; Two Persons, 1/6; Three or more, 6d. each. A Row round the Lake, each Person, 2d. All description of Boats on hire

All Day.

In South Nave.

BILLIARD AND SMOKING ROOM (OVERLOOKING THE GROUNDS).

All Day.

In South Nave (near High Level Entrance).

THE ELECTRIC STAIRWAY. Price One Penny.

All Day.

Near High Level Entrance.

PIERROT'S RIFLE RANGE.

The Latest Animated and Self-Indicating Electric Targets

All Day

In Gallery (above High Level Entrance).

MINIATURE BILLIARDS. 50 Up for 3d.

*20 Tables! Erected by J. R. Mally & Co., Goswell Road, London.
Tickets, 50 Up for 3d.*

All Day.

In South-Western Gallery.

HOLIDAY COURT.

Visitors will find this a very interesting Exhibition of Pleasure and Health Resorts in England, Scotland, Ireland, Wales, and the Continent. Pictorial Gallery Guide to Hotels, Hydros, Boarding Establishments, Furnished Houses and Apartments. Holiday Indicators for Holiday Makers, Tourists and Travellers. Permanent Exhibition; open all the year round. Admission Free.

9.30

In Cycle Track Enclosure (Cinder Track).

GREAT OPEN AMATEUR 50-MILE WALKING RACE FOR WORLD'S RECORD.

(Under A.A.A. Laws).

Promoted by, and under the management of,

The Blackheath Harriers and Surrey Walking Club.

Finish of Race, about 5.30 p.m.

For List of Competitors, see Special Programme.

Numbered Seats in Pavilion, 5/-; General Stand, 1/6; Uncovered Stand and Enclosure, 1/-

Special Arrangements To-day

7

10.0 till Dusk, in Grounds (near to Low Level Station).

GRAND PANORAMA, THE SIEGE OF PARIS, 1871. (Battle of Montretout).

Painted by the late F. PHILIPPOTEAUX. Also DIORAMA by the same Artist, a striking incident, during the Commune, in

THE CEMETERY OF PERÉ LA CHAISE.

ADMISSION SIXPENCE

10.30

In North Tower Gardens.

Brass Band Competition for the "Daily Express" Shield

And other Prizes, see page 2.

Grand Shield Section. *Adjudicator: Mr. R. Stead.*

<i>Name of Band.</i>	<i>Conductor.</i>	<i>Name of Band.</i>	<i>Conductor.</i>
Armley and Wortley ...	H. Mallinson	Irthlingborough ...	T. R. Preston
Barrow Shipyard ...	F. L. Traversi	Kettering Midland ...	R. Ryan
Bedford Town ...	C. H. Baker	Middlesboro' Borough...	J. Wilson, jun.
Blaina Lancaster Town	J. E. Fidler	Murton Colliery ...	A. Owen
Bolton Borough ...	W. Halliwell	Peterboro' Borough ...	T. R. Preston
Bradford City ...	W. Heap	Rawmarsh ...	F. Renshaw
Bristol Imperial ...	J. E. Wilkinson	Rhos ...	W. Rimmer
Burnley Temp... ..	A. Wilcock	Rotherham Borough ...	A. Owen
Burton Latimer Britan.	C. H. Baker	Rushden Volunteers ...	T. Seddon
Coseley	Squire Firth	Selby	T. Foster
East Kirkby Silver ...	R. Ryan	Silverdale	E. Booth
Enfield Town Foresters	F. Dimmock	Watford Artizans ...	T. R. Seddon
Fulham Borough ...	R. Dawson	Walthamstow Silver ..	J. Reay
Gainsborough Britannia	S. Schofield	Walthamstow Temp. ...	W. F. Gillyatt
Hampstead	J. Reay	Ystalyfera Temp. ...	C. A. Morgan
Handsworth Woodhouse	J. W. Cook	1st V. B. Ryl. Lanc., Ulverston	J. M. Carter
Hull Waterloo	C. Norman		

11.0

In Grand Terrace Bandstand.

Brass Band Competition for the "Daily Graphic" Challenge Cup

And other Prizes, see page 3.

Junior Cup Section. *Adjudicator: Mr. J. Walker.*

<i>Name of Band.</i>	<i>Conductor.</i>	<i>Name of Band.</i>	<i>Conductor.</i>
Altrincham Borough ...	H. Derbyshire	Higham Ferrers Town	J. K. Skinner
Bedminster Silver ...	J. H. Wilkiuson	Ilford Horns	H. Carl Taylor
Belvedere Excelsior ...	E. Alder	Kettering Victoria Missn.	W. East
Bexley Heath United ...	W. G. Hales	Longridge St. Lawrence	W. Heap
Birmingham City ...	W. F. Rowe	Maesteg Volunteers ...	W. Jury
Bourneville	E. Nash	Parkgate Excelsior ...	W. Heap
Brownley Silver... ..	T. Bewick	Peterboro' Excelsior ...	C. H. Baker
Carlton Temp.	J. W. Stamp	Rothwell Rifles... ..	R. Ryan
Chapelton Subscriptn.	A. Platts	Trapston Town... ..	N. Smith
Chesbam	W. Greenwood	Wilson, Son & Co., Hull	F. Renshaw
Crosfield's Soap Works	W. Halliwell	Wombwell Temp.	J. Brier
Grimsby Borough	G. Quarmby	Yiewsley... ..	E. Brophy
Halesowen Temp.	F. Hughes	Ystradgynlais Temp. ...	H. Williams

From 12.0

In New Dining Room.

Table d'Hôte Lunch at 2/6, consisting of Hors d'Œuvres, Fish, Entrée or Joint, Vegetables and Sweets. Also A LA CARTE and GRILL.

All Day
FROM
10 a.m.

Exhibitions & Attractions.

SOUTH NAVE.

Natural History Tableaux and Jungle.—South-East Gallery.

The Crystal Palace Arcade.—CLOCK GALLERY. The most attractive Fancy Fair in London.

Camera Obscura.—SOUTH-EAST GALLERY. Admission 3d.

Royal Exhibition of Working Ants.—CLOCK GALLERY. Six different Species of Living Ants always on view, with their Queens, Workers, Slaves, Domestic, Cows, &c. Curiosities of Ant Life. Admission 3d.

Pompeian House.—South Transept.

The Palace Wild Sports Rifle Range.—BASEMENT FLOOR, facing Main Entrance from Grounds

Billiard and Smoking Room (overlooking the Grounds)

NORTH NAVE.

Egyptian, Greek, Roman, Alhambra, Byzantine, Mediæval, and Renaissance Courts.—Full of magnificent Replicas of the World's Priceless Art Treasures

Reading Room.—Open from 10 a.m. till close of Palace. All the Morning and Evening Papers, as well as many of the Provincial, Scotch, Irish, and Foreign Newspapers, Magazines, and Reviews. Accommodation for Letter-writing, Postage Stamps, Paper, &c. Latest Telegraphic Dispatches Day Tickets, 2d. Annual Admission Tickets, 21s. Six months, 12s. 6d. Three months, 7s. 6d. One month, 3s.

Lending Library.—Annual Subscription, 21s. Six months, 12s. 6d. Three months, 7s. 6d.

Ethnological Tableaux.—North-East Gallery.

Monkey and Parrot House and Aquarium. ENTRANCE NEAR LIBRARY.—Specimens of Indian Fish, lent by the King. Eighteen kinds of fresh water fish fed daily at 4 p.m.

WESTERN ANNEXE.

Crystal Palace Exhibition Printing Works (Messrs GUY WHITTEM & Co.), adjoining High Level Main Entrance. Printing Machinery in operation from morning till night.

IN GROUNDS.

Crystal Palace Company's Gymnasium and School of Physical Culture, Boxing, Fencing, and Swimming.—Entrance from North Tower Gardens.

The School is open for Classes Daily 9 a.m. till 8 p.m. Saturdays, 9 till 1 and 3.30 till 5.

Separate Days for Ladies and Gentlemen.

Free Tickets of Admission to the Palace provided for Pupils.

Special attention is given to Curative Exercises, Symmetrical Development, Department, Figure Culture and Breathing Exercises.

Holiday Classes for Boys and Girls at special terms.

Heated Swimming Bath.

For Particulars apply to FRANK A. HANSARD, Director of the Schools.

North Tower. ENTRANCE FROM NORTH NAVE.—Upwards of 200 feet above the Cross of St Paul's, and 700 feet above the level of the Thames. Picturesque panoramic prospect from Gallery, extending into eight counties.

Ascent by Lift, Adults, 6d.; Children, 3d.

Ascent by Stairs Adults, 3d.; Children, 1d.

The Maze. Admission 3d.

Switchback Railway. Return Fare, 3d.

Swings, Roundabouts, etc.

Cycle Track, Polo Ground, Lakes, Geological Islands, &c.

TRAIN SERVICE.

L. B. & S. G. (Low Level).				S. E. & C. R. (High Level).							
To LONDON BRIDGE.		To VICTORIA.		To CITY.		To VICTORIA.					
1 18	4 50	8 17	1 15	4 58	8 15	1 33	5 58	—	1 16	7 38	—
2 25	5 34	18 31	1 39	5 12	8 45	2 25	6 21	—	2 3	8 15	—
2 52	5 50	8 55	2 12	5 41	9 2	3 12	6 35	—	2 42	8 48	—
12 35	6 2	10 20	2 22	5 52	10 15	3 27	7 9	—	3 23	9 48	—
12 37	16 32	10 55	3 2	6 1	10 35	3 51	7 55	—	4 3	10 10	—
13 4	6 40	11 51	3 48	6 20	11 0	4 23	8 35	—	4 55	11 0	—
3 18	6 46	—	4 0	6 38	11 19	4 42	9 25	—	5 35	11 43	—
7 21	7 14	—	15 14	6 52	11 27	4 44	10 30	—	5 36	—	—
4 5	7 42	—	4 17	7 40	12 27	5 20	11 15	—	5 6 10	—	—
14 25	18 8	—	4 45	7 52	—	5 48	—	—	6 55	—	—

† via Tulse Hill

‡ Saturdays only

* Not on Saturday

Special Fast Trains in Black Type.

CRYSTAL PALACE GROUNDS (200 Acres) AND GUIDE THERETO.

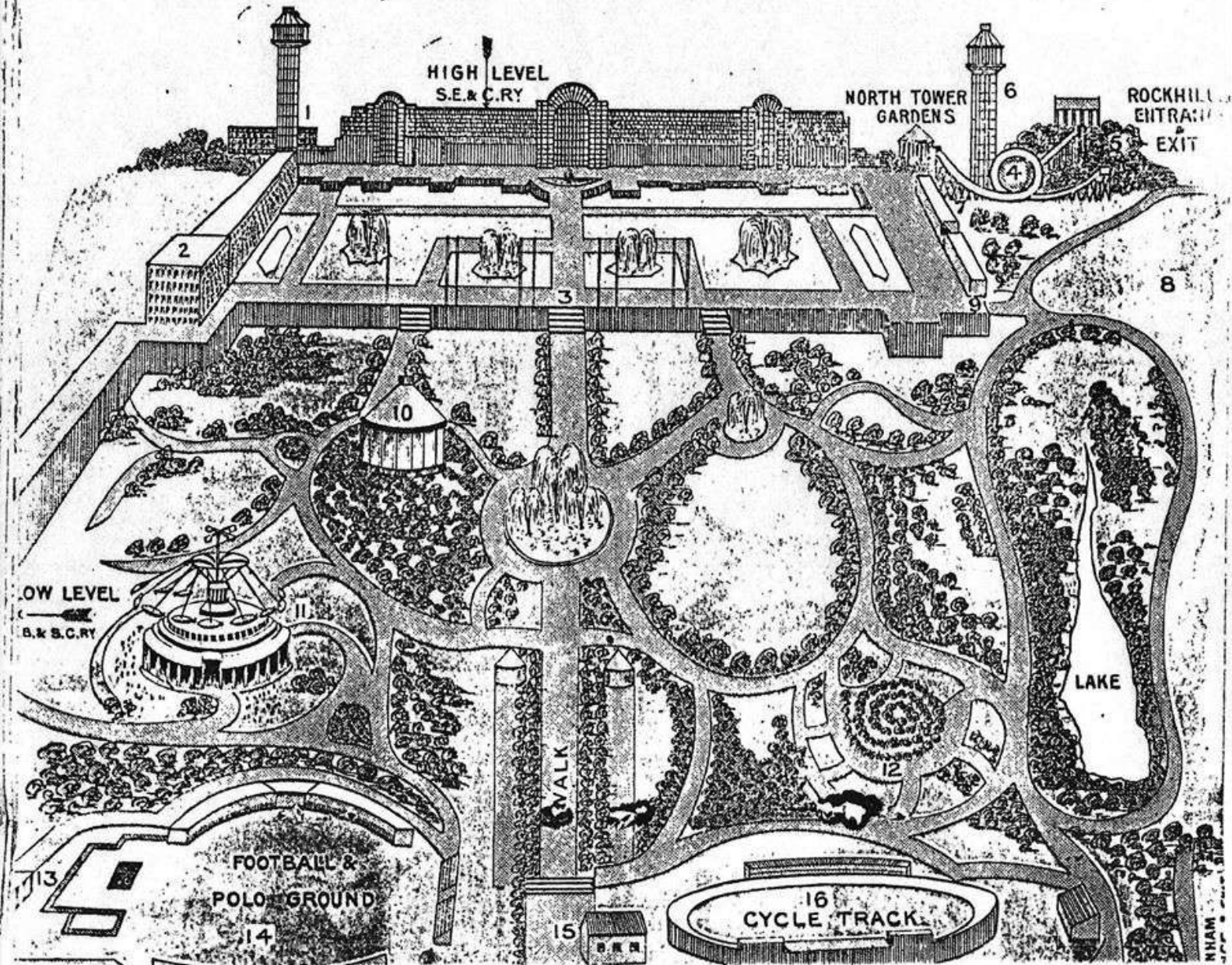

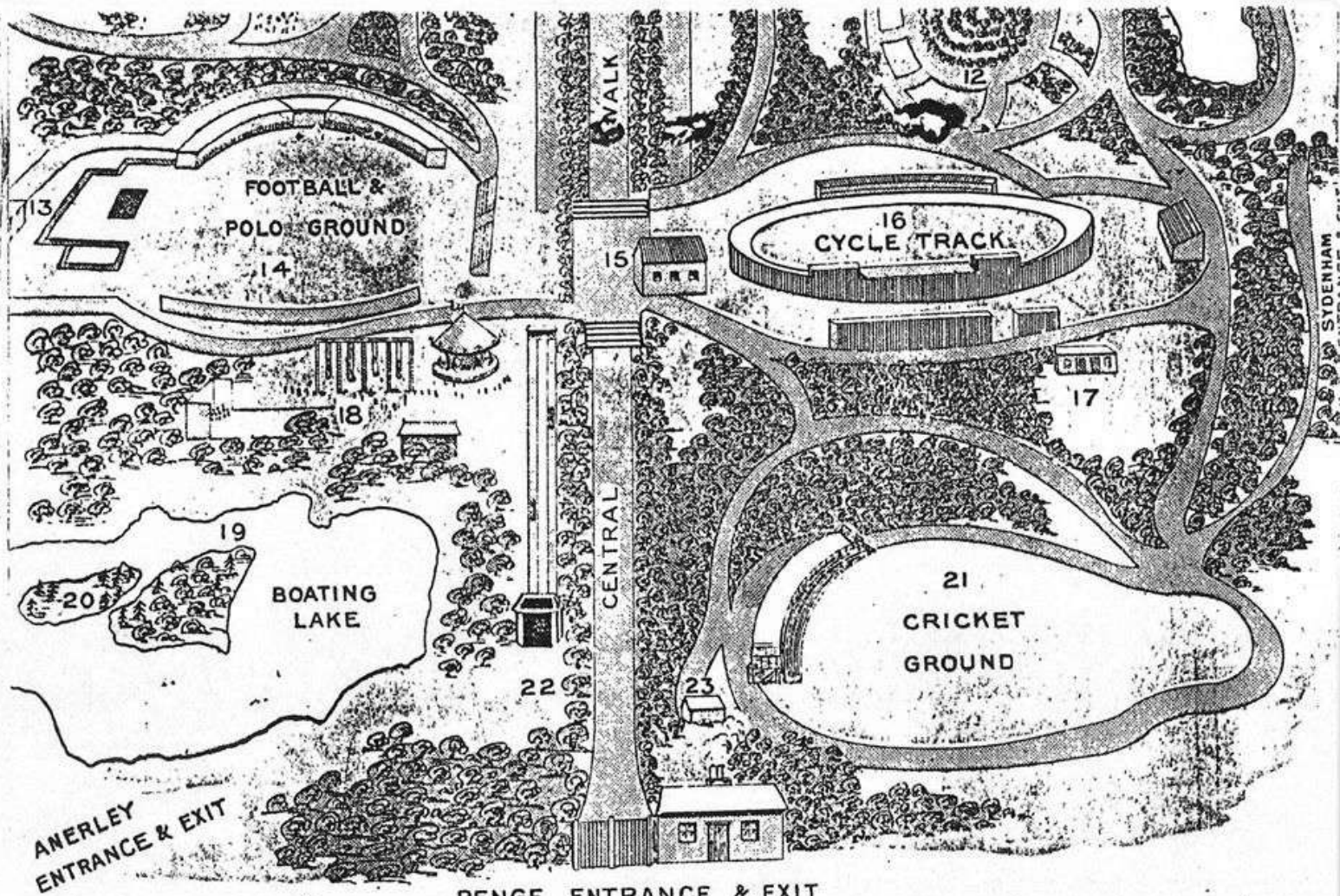

PENGEE ENTRANCE & EXIT

PENGEE STATION
L.B. & S.C.R.

PENGEE STATION
S.E. & C.R.

REFERENCE.

- 1. Crystal Palace Co.'s School of Practical Engineering.
- 2. " " School of Art, Science & Literature.
- 3. Firework Terrace.
- 4. Topsy Turvy Railway.
- 5. Water Chute and Rapids.
- 6. North Tower—Ascent by Lift.
- 7. Crystal Palace Co.'s School of Physical Culture.
- 8. Balloon Ground.

- 9. Dancing Platform.
- 10. Panorama.
- 11. Maxim Flying Machine.
- 12. Maze.
- 13. Polo Stables
- 14. Football and Polo Ground.
- 15. Aerodrome
- 16. Cycle Track.

- 17. Bowling Greens.
- 18. Swings, Roundabouts, etc.
- 19. Boating Lake.
- 20. Extinct Animals.
- 21. Cricket Ground.
- 22. Switchback.
- 23. Lavatories.

For Plan of Interior of Building, see next page.

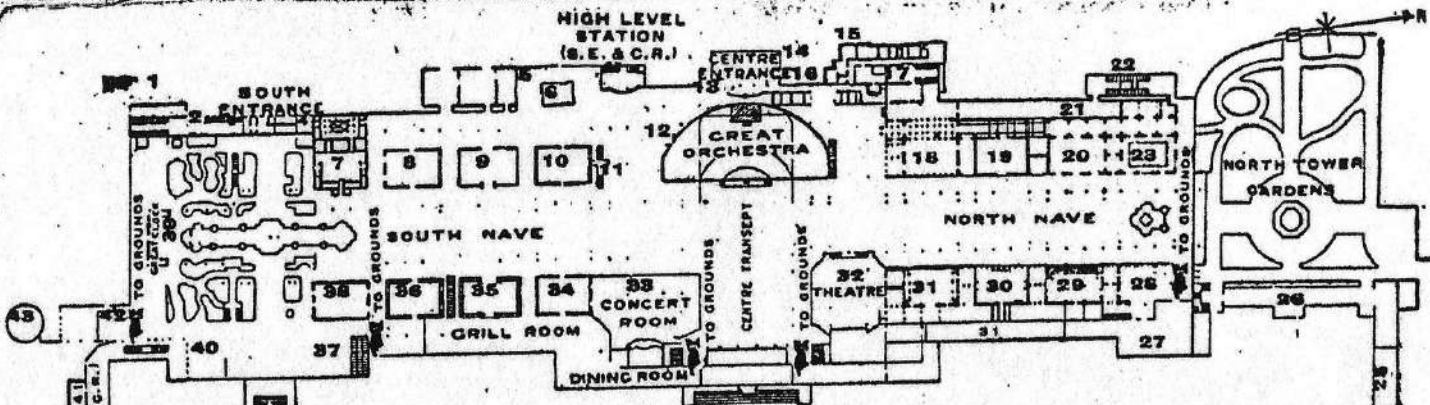

PLAN OF MAIN FLOOR.

- | | | |
|---|---|--|
| <ol style="list-style-type: none"> 1. Ladies' Lavatories 2. Gentlemen's Lavatories 3. Police Enquiry Office 4. Hairdressing Saloon 5. Rifle Range 6. GUY WHITTEM'S Printing Works 7. Pompeian House (Free) 8. Chinese Court 9. Industrial Court 10. Entertainment Court 11. Electric Stairway 12. CLOAK ROOM 13. SEASON TICKET OFFICES 14. Fire Office 15. Post and Telegraph Office | <ol style="list-style-type: none"> 16. GENERAL OFFICES 17. Ladies' Lavatories 18. Egyptian Court (Free) 19. Greek Court (Free) 20. Roman Court (Free) 21. Ladies' Lavatories 22. Gentlemen's Lavatories 23. Alhambra Court (Free) 24. North Tower 25. School of Physical Culture 26. Monkey House (Free) 27. Library and Reading Room 27. (Below) Lower Skating Rink 28. Byzantine Court (Free) 29. Mediaeval Court (Free) | <ol style="list-style-type: none"> 30. Renaissance Court (Free) 31. Crystal Palace Club Rooms 32. Theatre 33. Concert Room 34. Tea Room 35. RUSSELL'S Photographic Studio 36. Canadian Court (Free) 37. St. John's Ambulance Depot 38. Music Court 39. Great Clock, Fountain & Bandstand 40. Smoking and Billiard Room 40. Ladies' Lavatories 41. Dining Room, and Garden Hall 42. South Tower, and School of Eng'g. 44. School of Art, Science & Music |
|---|---|--|

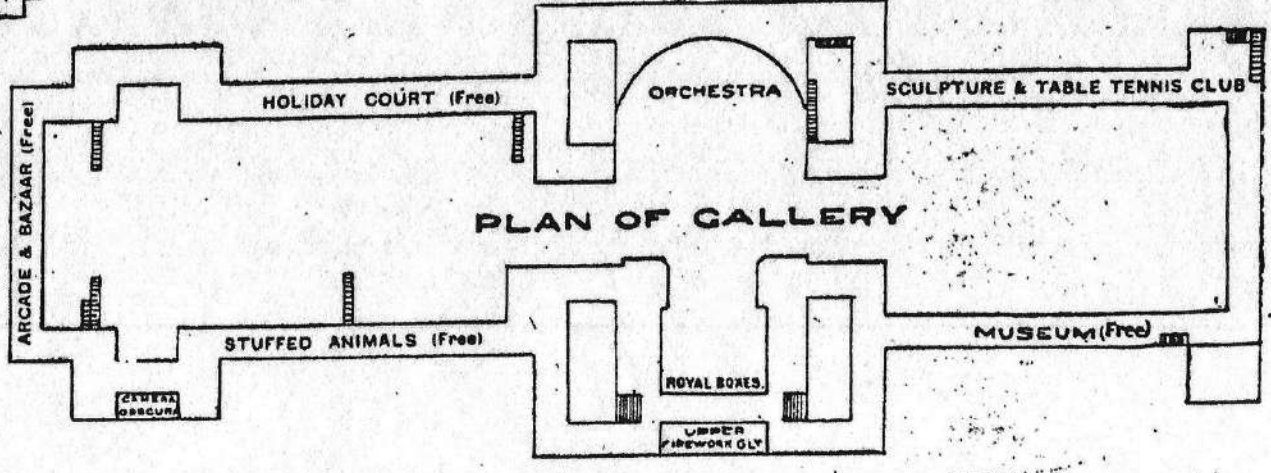

PLAN OF GALLERY

For Plan of Grounds, see inside pages.

Special Arrangements To-day

11.30 continued

Name of Band.	Conductor.	Name of Band.	Conductor.
Abertillery Silver	... L. Allison	Lee Mount	... A. Owen
Besses o' th' Barn	... A. Owen	Lindley	... B. Lodge
Black Dike Mills	... J. Gladney	Linthwaite	... A. Gray
Cleckheaton Victoria	... A. Holden	Luton Red Cross	... A. Holden
Dannemora Steel Works	R. Richford	Pendleton Old	... A. Gray
Ferndale	... S. Radcliffe	Raunds Temp.	... C. H. Baker
Hebburn Colliery	... A. Holden	Rushden Temp.	... A. Owen
Hebden Bridge	... W. Heap	Rise Carr Rolling Mills	W. Heap
Irwell Springs	... W. Rimmer	ShIPLEY	... J. Paley
Kettering Rifles	... A. Owen	Wingates Temp.	... W. Rimmer
Kettering Town	... R. Ryan	Wyke	... A. Gray
Kirkby-in-Ashby Temp.	J. Gladney	3rd V.B. Welsh Regt.	J. Griffiths

12.0

In South Nave (Crystal Fountain Band Stand).

Reed Band Competition for the "Pearson's Weekly" Shield, "Crystal Palace" Cup,

And Prizes, see page 3.

Reed Band Section. Adjudicator: Mr. W. Short, L.R.A.M.

Name of Band.	Conductor.	Name of Band.	Conductor.
Dewsbury & Distct. Mil.	A. Gray	St. Joseph's, Longsight Street	F. Owen
Dorking Town	... Jno. Ord Hume	1st V. B. Buffs	... F. E. Huish
East Ham Town Mil.	... W. J. Leslie	3rd V. B. Essex	... W. P. Thorne
Greenwich Borough Mil.	C. S. Birkhead	4th V. B. Notts	... W. Grant Jones
Mirfield Baptist Mil.	... Gill Brearley		... W. Belcher
Mogg's Military	... H. Mogg		

12.0

North Side of Cricket Ground.

The Boys' Band Competition for "Woods" Challenge Cup.

And Prizes, see page 3.

Boys' Band Section. Adjudicator: Mr. J. A. Browne.

Name of Band	Conductor.	Name of Band.	Conductor.
Ardwick Green Ind. Sch.	G. Taylor	Liverpool Boys' Refuge	J. Heron
Chase Farm, Enfield	... W. Styles	Poplar Training School	S. T. Webber
Derker Council School	S. Howcroft	St. Joseph's, Longsight	F. Owen
Greenwich & Deptford Sc.	A. R. Byles	St. Joseph's, Orpington	T. Burt
Holborn School	... J. F. Beeson	St. Marylebone Schls	J. Dykes
Kensington & Chelsea Scs.	J. Fisher	Shirley Schools	... J. Machell
Lambeth Parish Schools	H. Godfrey	Strand Schools	... L. P. Connor

20

Adjoining North Tower Gardens (Weather permitting).

CAFE CHANTANT.

PROGRAMME.

- 1 OVERTURE.
- 2 **Nellie Chandos.** Burlesque Artiste.
- 3 **Alf Hales.** Actor Vocalist.
- 4 **Elina Duo.** Eccentric Dancers.
- 5 SELECTION, "The Girl from Kay's" *Ivan Caryl*
- 6 **The Davenports.** Magic and Mystery.
- 7 **Walter Wallis.** Quaint Comedian.
- 8 **The Butterfly Troupe.** Vocalists and Dancers.

THE LADIES' BUTTERFLY BAND.

Conductress—**MDLLE. D'ALGER.**

Seats . . . *One Shilling, Sixpence, and Threepence.*

NOTE.—Should the weather be unfavourable the CAFE CHANTANT will take place inside the Palace in the Theatre.

Special Arrangements To-day

3.0

On Polo Ground.

LONDON POLO CLUB.**POLO MATCH.**

FOLLOWED BY MEMBERS' GAMES.

The Polo Pavilion is open to Members and Friends only. Tea and Refreshments can be obtained.

4.30

On Grand Terrace.

**STUPENDOUS AERIAL ACT by
ORION, on the High Wire.****THE CRYSTAL PALACE MILITARY BAND.**

Conductor—MR. HERBERT GODFREY.

5.0

In Theatre.

CAFE CHANTANT.

For Programme and Prices, see 2.0 Performance.

6.0 till 7.30

In North Tower Garden Bandstand (Weather permitting).

THE CRYSTAL PALACE MILITARY BAND

Conductor—MR. HERBERT GODFREY.

MARCH, "Unser Heinrich"	W. Paris Chambers
OVERTURE, "Macbeth" Sullivan
LIED, "La Serenata" Braga
SELECTION from "The Cherry Girl"	Ivan Caryll
* Selected from the following—Opening Chorus (Act II.)—Song, Telephone to the Moon—Song, Pansy—Song, Naughty just for once—Solo and Chorus, Bubble Land—Song, Miss Innocent—Song, The Coming of the Dawn—and Valse (Fina'e).	
VALSE, "Manolo"	Waldteufel
THE TURKISH PATROL Michaelis
REMINISCENCES OF ROSSINI	Fred Godfrey

Giacchino Rossini was born at Pesaro, in Italy, in 1792. During the earlier part of his life there seemed to be no limit to the fertility of his musical ideas (as may be proved by a glance at the huge volume of the British Museum catalogue of published music devoted to his works), but after the year 1829, when his "William Tell" was produced in Paris, he composed little or nothing further except the "Stabat Mater" and his "Messe Solennelle," although he lived till 1868, on the 13th November of which year he died at the French capital.

6.0 till 9.0

In New Dining Room (South Nave, overlooking Gardens).

MODERATE TAFFIFF.

DINNERS, 5/-; ALSO à la Carte and Grill till 10.0 p.m.

To-day, "The Firework Dinner," 6/-

J. LYONS & CO., Ltd., Caterers by Appointment.

THE CRYSTAL PALACE COMPANY'S SCHOOL OF ART, MUSIC, AND LITERATURE. 1904-1905.—LADIES' DIVISION.

OPENING OF THE FORTY-FIFTH SESSION.

THE INAUGURAL LECTURES.*The remaining Lectures will be held on*

Tuesday, Oct. 4 ... "Tragedy and Comedy" REV. R. H. U. BLOOR, B.A.

Tuesday, Oct. 11 ... Pianoforte, Violin, and Violoncello Recital MESSRS. BONAWITZ, AVES, AND CRIBB

The Lectures will take place at 5.30 in the School of Art Lecture Hall, and Tickets for Admission can be obtained

Special Arrangements To-Day

7.0

On Handel Orchestra.

Numbered Seats 2/6, and Unnumbered Seats 1/-, on Sale at Ticket Office all day

NOTE.—Large numbers of people were disappointed last year in getting Seats through leaving the purchase of Tickets until late in the day. Tickets should be bought at the earliest possible moment.

GRAND FESTIVAL CONCERT BY THE Massed Bands.

Assisted by **MR. W. PARIS CHAMBERS**, the great Cornet Virtuoso.

BANDS.

Besses o' th' Barn.
Ferndale.
Irwell Springs.
Kettering Rifles.
Lee Mount.
Lindley.

Linthwaite.
Luton Red Cross.
Pendleton Old.
Rushden Temperance.
Wingates Temperance.
Wyke.

The Pipers of the Scots Guards,

AND

The Drum and Fife Band of the Scots Guards.

PROGRAMME.

1. MARCH, "The University" *J. H. Carter*

Conducted by **MR. J. HENRY ILES**.

A splendid march, written partly in the American and partly in the Continental style.

2. PART SONG, "Sweet and Low" *Barnby*

Conducted by **MR. J. HENRY ILES**.

This popular Part Song needs but little introduction. It is first favourite with all choral societies, and the Bands will give a splendid illustration of a Brass Band's power and command of their instruments in producing soft, rich, impressive and organ-toned effects.

3. GRAND FANTASIE for B flat Cornet, "Les Majestique" *Paris Chambers*

With Pianoforte Accompaniment by MADAME CHAMBERS.

Introducing *Cadenza Bravuro*, compass from C [second line below F clef] to G in Alt. [fourth ledger line above Treble clef].

W. PARIS CHAMBERS, the famous American Cornettist.



This Block portrays **MR. PARIS CHAMBERS**, the eminent Cornet virtuoso, holding the instrument by the centre valve suspended against his lips while he plays a truly remarkable cadenza, ranging over four octaves! His system of "facial culture" for Cornet players is unique, and **MR. CHAMBERS** himself is certainly a splendid testimonial to its efficiency.

7.0 continued



Some Wonderful Notes played by Mr. CHAMBERS.

4. SOLDIERS' CHORUS from "Faust" Gounod

Conducted by Mr. S. COPE.

This chorus is probably the best known movement from Gounod's most popular opera. The opera was first produced at the Theatre Lyrique on March 19th, 1859, and at once placed Gounod in the front rank of composers. The first performances in England were at the Royal Italian Opera in July, 1863, and in English at Her Majesty's Theatre, January, 1864.

5. GRAND SELECTION, "Die Meistersinger" Wagner

BESSES O' TH' BARN BAND.

Conducted by Mr. ALEX. OWEN.

This famous band was successful last year in carrying off the One Thousand Guinea Trophy and the Championship of Great Britain with their performance of this piece.

6. MARCH, "Amicizia" Paris Chambers

Conducted by the COMPOSER.

Mr. Chambers is not only a marvellous Cornet player but also an excellent composer and arranger. This March in purely American style is most popular all over the country.

7. CORNET SONGS—(a) Berceuse in C Godard

- (b) "Lorelei" Liszt

With Pianoforte Accompaniment by MADAME CHAMBERS.

W. PARIS CHAMBERS.



A Cadenza played by Mr. CHAMBERS.

Special Arrangements To-day

7.0 continued

8. HYMNS—(a) "Edwinstone" *Baird*
 (b) "The Last Wish" *Baird*

Conducted by MR. J. HENRY ILES.

The first Hymn is a great Band favourite, and has been in the repertoire of all the leading Bands for many years.

"The Last Wish" was the favourite Hymn of the late Mr. Edwin Swift, the well-known conductor, and is now rendered as a tribute to his memory. He was present at last year's Festival. The Brass Band World will feel his loss very keenly.

[During the playing of this last piece the audience are requested to stand.]

9. CORNET SONGS—(a) "Hossana" *Granier*
 (b) "Inflamatus" *Rossini*
 W. PARIS CHAMBERS.

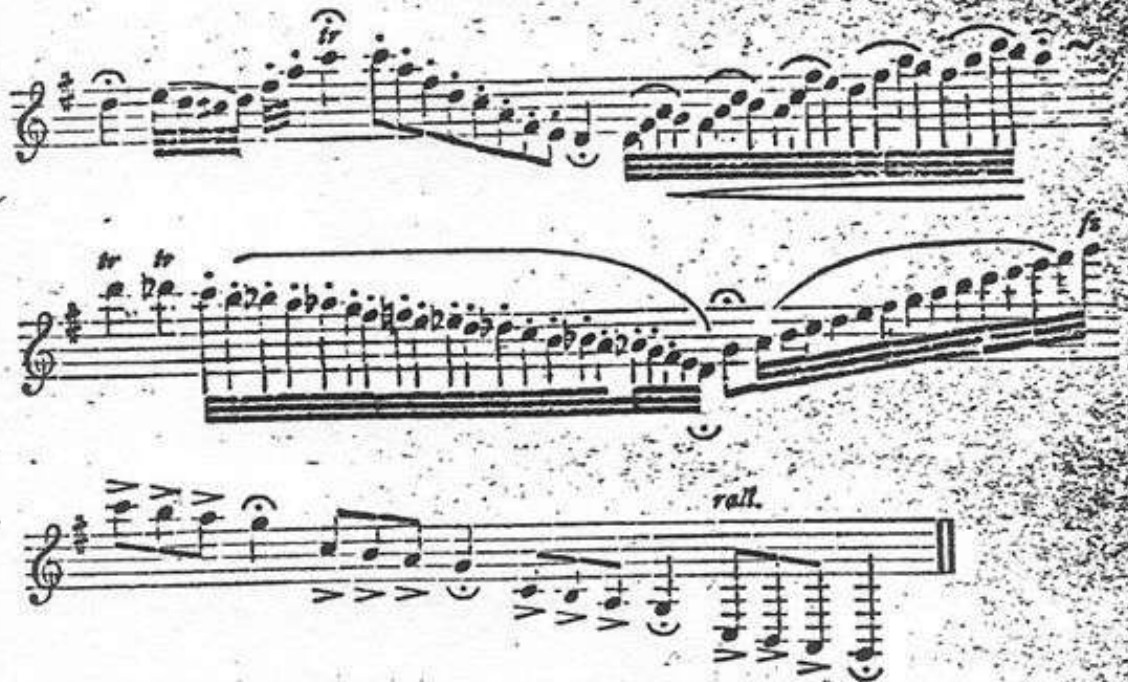

Another Wonderful Cadenza played by Mr. CHAMBERS.

10. "GRAND BATTLE PIECE, "A Soldier's Life" *W. J. D. Sheriff*

THE MASSES BANDS.

Conducted by MR. W. J. D. SHERIFF.

The discharge of a gun announcing daybreak—"The Reveille"—Orders for abroad, "The Soldier's Tear" (cornet solo)—The regiment marches off to the ship to the tune of "The girl I left behind me"—The soldiers embark, "Then you'll remember me" (baritone and solo cornet)—"The Anchor's weighed"—"Farewell, ye Portsmouth Town"—(Euphonium cadenza and solo)—"Rocked in the cradle of the deep"—Jig—Trombone cadenza and solo, "The Bay of Biscay"—Sailor's Hornpipe—Storm—Prayer during storm—Fine weather again—Song, "Under the twinkling starlight"—Landing—Advance of Guards, "The British Grenadiers"—Advance of Scotch regiments—Lights out—Night—(Cornet solo), "The Alarm"—Commences firing—The Battle—Victory, "See the conquering hero comes."

* During the performance of the battle-scene the firing of huge guns and explosion of shells will be heard.

The Bands will be assisted by the Pipers, Drummers, and Fifes of His Majesty's Scots Guards.

In this piece will be introduced the rumble and roar of the great Drum (12 feet high), kindly lent by Messrs. Boosey & Co.

NOTE.—Immediately after the last piece the Prize-Winners will be announced. The names of the Winning Bands will appear on the Screen.

GOD SAVE THE KING.

Numbered Seats, 2/6.

Unnumbered, 1/-.

90 LAST GRAND FIREWORK DISPLAY

By Messrs. C. T. BROCK & CO.

CAUTION.—Neither the Crystal Palace Company nor Messrs. C. T. Brock & Co. will be responsible for any damage incurred by Visitors who remain in the Grounds below the Terrace during the Fireworks. A Signal will be fired Half-an-Hour before the commencement of the Display.

1. Detonating Shell, exploding aloft and announcing the commencement of the Display.
2. Salvo of Single Rockets, fired at intervals, and emitting Stars of every colour.
3. Signal Aerial Maroon, announcing
4. Grand Illumination of the Grounds by large and powerful masses of Coloured Fire, arranged to produce the most beautiful changing effects on the foliage, flowers, fountains, lakes, lawns, and statuary.
5. Ascent of Gas Ballons, with Radium Light and shooting Fireballs, one balloon being driven by aerial motor with sparking action.
6. Living Firework Drama—THE FIRE SCENE—
 1. The outbreak of fire. 2. Discharge of Brock's Patent Signal and Flash Fire Call Signal. 3. Arrival of Merryweather's Motor Fire Engine, manned by Living Firemen. 4. Laying out the Hose. 5. Fire extinguished by jet of Fire.
7. The Swarm of Dragonflies, produced by the simultaneous flight of a number of large rockets.
8. The Clusters of Turquoises and Emeralds, produced by the simultaneous flight of a number of large shells.
9. The Mosaic Hexagon Stars.
10. The Aerial Festoons of Crown Jewels, released from a number of special rockets, which, when at an immense height, detach chains of stars that continually change colour as they slowly descend.
11. The Marionette Skeletons.
12. The Triplets, formed by the discharge of Brock's Repeating Bombs.
13. DEVICE. The Huge Circular Sun, with repeated changes of form and colour.
14. Lightning Flashes, produced by the ascent of Brock's new rockets.
15. The Wreath of Roses, produced by the simultaneous flight of a number of shells.
16. HUMOUROUS MECHANICAL DEVICE. The Cock Fight. A furious fiery encounter between rival pyro-chanticleers.
17. The Clusters of Liquid Rubies, produced by the simultaneous ascent of large rockets.
18. The Peacock in life-like movement.
19. The Cloud of Amber and Amethysts, produced by the simultaneous flight of a number of large shells.
20. "Hickory, Dickory, Dock,
The Mouse ran up the Clock!" etc.
21. The Shower of Electric Rain, produced by the simultaneous flight of a number of large rockets.
22. The Oriental Fountain, flanked on either side by a large Maypole.
23. The Coronation Bouquet, produced by the simultaneous flight of a number of large shells.
24. The Prismatic Wheels. A beautiful colour effect in changing forms, emitting the many coloured rays of the spectrum. A new and interesting form of elaborate revolving work.
25. Ascent of Radium Rockets, a novelty of 1904, of intense brilliance.
26. GREAT PUZZLE PICTURE. Find the Animals in the Forest.
27. Salvo of Huge Shells, 25, 32, 38, and 50 ins. in circumference, comprising The Crystal Light Ball, The Brockite Flash and Sound Signals, The Quadruple Shell, The Golden Shell, Jupiter's Thunderbolt, and many other beautiful effects of form and colour introduced by C. T. Brock & Co.
28. Flight of Whistling Rockets, as introduced by C. T. Brock & Co., and always creating great interest and amusement by their weird sound.
29. The Oriental Carpet, designed in rich colouring and surrounded by a fringe of gold.
30. The Clusters of Liquid Pearls, produced by the simultaneous ascent of a number of large rockets.
31. The Clusters of Harebells and Daffodils, produced by the simultaneous flight of large shells.
32. The Niagara of Fire, a torrent of molten gold, covering an area of many thousand square feet, falling from a height of 100 feet with a roar resembling a cataract, and rebounding in a brilliant fiery-spray.
33. The Weird White Waterfall.
34. The Aerial Harlequinade, produced by the simultaneous flight of a number of large shells of various calibres.
35. The Showers of Silvery Dewdrops. A novelty of this Season.
36. The Pearls of Light Streamers.
37. Grand Melee by multitudes of Shells, Coloured Roman Candles, Saucissons, Glow-worms, Cobras, etc., and special illumination of the scene with coloured and silver spray.
38. The Fairyland Glimpse, permitted by the discharge of large Coronation Shells which give a sudden and brilliant illumination of the scene and spectators.

SEATS: Numbered Reserved in King's Corridor, 2/6

Followed by a GRAND DISPLAY OF THE ELECTRIC FOUNTAINS.

Gallery over King's Corridor, 1/- On Slopes, 6d.

9.0 till 9.30

In Grand Terrace Bandstand.

THE CRYSTAL PALACE MILITARY BAND.

Conductor—MR. HERBERT GODFREY.

9.45 till 10.30

In North Tower Garden Bandstand (Weather permitting).

THE CRYSTAL PALACE MILITARY BAND.

Conductor—MR. HERBERT GODFREY.

SELECTION from "The Orchid" *Ivan Caryl*

Selected from the following: Octet, Off to the Ball—Song, Advertisements—Quintet, Oh Mr. Registrar—and Songs, Little Mary—Fancy Dress—Come Along With Me—From Far Peru—The Emperor of Sahara—I must propose to you—Bedelia—and Valse and Finale, Act I.

SOLO FOR CORNET, "I'll sing thee songs of Araby" *Clay*
MR. HERBERT GODFREY.

VALSE, "Toujours ou Jamais" *Waldteufel*

REMINISCENCES OF THE PLANTATION *Chambers*
Including—My old Kentucky Home—Old Zip Coon—Way down upon the Suwanee River—Essence of Old Virginy—Poor Old Joe—Dixie—and Massas' in de cold, cold ground.

THE POPULAR

Six o'clock Promenade Concerts

Will be resumed in the Concert Room on

MONDAY NEXT, OCTOBER 3rd, 1904.

ARTISTES FOR WEEK ENDING OCTOBER 8th—

- Monday, October 3rd ... Miss JESSIE GOLDSACK and Mr. FREDERIC RANALOW.
- Tuesday, October 4th ... Miss AGNES FENNINGS and Mr. REGINALD BROPHY
(Solo Pianoforte).
- Wednesday, October 5th... Miss SARA SILVERS and Mr. DALTON BAKER.
- Thursday, October 6th ... Miss LUCY MURTAGH and Mr. A. H. GEE.
- Friday, October 7th ... Miss JESSIE RAYNE and Mr. ANDERSON NICOL.
- Saturday, October 8th ... Miss ELEANOR FELIX and Mr. ARTHUR STRUGNELL.
At 6.30 p.m.

ARTISTES FOR WEEK ENDING OCTOBER 15th—

- Monday, October 10th ... Miss MARGARET CRAWFORD and Mr. RICHARD GREEN.
- Tuesday, October 11th ... Miss HILDA STAPYLTON and Mr. GWILYM RICHARDS.
- Wednesday, October 12th ... Miss OLIVE HOOD and Mr. CHARLES COPLAND.
- Thursday, October 13th... Miss FREDRICA RICHARDSON and Mr. ERNEST PIKE
- Friday, October 14th ... Miss DORA BECK and Mr. FOLEY BANKS.
- Saturday, October 15th... Miss VIOLET LUDLOW and Mr. CHARLES BENNETT.
At 6.30 p.m.

THE CRYSTAL PALACE MILITARY BAND.

CONDUCTOR—MR. HERBERT GODFREY.

AT THE PIANO—MR. WALTER W. HEDGCOCK.

SEATS FREE. A few Reserved Seats, SIXPENCE.

CRYSTAL PALACE MAGAZINE.

PUBLISHED MONTHLY.

1d.

ON SALE AT ALL THE STALLS.

FORTY-NINTH ANNUAL SERIES OF

SATURDAY CONCERTS.**October 8th, at 3.30 p.m.**

VIOLIN RECITAL BY

FLORIZEL VON REUTER

(The Marvellous Child Violinist and Composer),

Assisted by Miss Martha Cunningham and Mr. Warden Wynne, Vocalists; Miss Evelyn Stuart, Pianist; and Mr. Charlton Keith, Accompanist.

Numbered Seats, 4/- & 2/- Unnumbered, 1/-

October 15th, at 3.30 p.m.

VOCAL RECITAL BY

MISS MURIEL FOSTER.

Assisted by Miss Polyxena Fletcher, Solo Pianist; and Miss Kate Eadie, Accompanist.

Numbered Seats, 4/- & 2/- Unnumbered, 1/-

October 22nd, at 3.30 p.m.**KUBELIK RECITAL.**

The following Artists will assist KUBELIK: Miss Muriel Gough, Vocalist; Miss Katharine Goodson, Solo Pianist; and Mr. Ludwig Schwab, Accompanist.

Numbered Seats, 7/6 & 5/- Unnumbered, 2/6.

October 29th, at 3.30 p.m.

VOCAL AND VIOLIN RECITAL BY

MR. PLUNKET GREENE

AND

Mons. ZACHAREWITSCH.

Accompanist, Mr. Samuel Liddle.

Numbered Seats, 4/- & 2/- Unnumbered, 1/-

There will be no Concert on November 5th.

November 12th, at 3.30 p.m.

RECITAL BY

MISS FANNY DAVIES, Pianoforte.**MISS MAUD MacCARTHY, Violin.****MR. FREDERIC AUSTIN, Vocalist.**

Numbered Seats, 4/- & 2/- Unnumbered, 1/-

November 19th, at 3.30 p.m.

VOCAL & VIOLONCELLO RECITAL

BY
DR. THEO. LIERHAMMER

AND

MONS. HOLLMANN.

Accompanist, Mr. Samuel Liddle.

Numbered Seats, 4/- & 2/- Unnumbered, 1/-

November 26th, at 3.30 p.m.

VOCAL RECITAL BY

MISS ELIZABETH PARKINA

(of the Royal Opera, Covent Garden, etc.)

Assisted by Miss Dorothy Maggs, Pianist; and Mr. Roban Clensy, Violinist.

Accompanist, Mr. Frank Mummery.

Numbered Seats 4/- & 2/- Unnumbered, 1/-

December 3rd, at 3.30 p.m.

CONCERT BY THE

CRYSTAL PALACE ORCHESTRAL SOCIETY,

ASSISTED BY

The Crystal Palace Choir.

300 Performers.

The Programme will include—

Haydn's Oratorio, "THE CREATION," and a Miscellaneous Programme including a new Orchestral Suite.

Conductor - MR. WALTER W. HEDGCOCK.

Numbered Seats, 4/- & 2/- Unnumbered, 1/-

Numbered Seats may be booked at the Crystal Palace Ticket Office, and at the usual London Agents.

WEDNESDAY & THURSDAY NEXT, October 5th and 6th.

NATIONAL CHRYSANTHEMUM SOCIETY'S EARLY SHOW

SATURDAY, October 8th.

London County Cricket Club's Autumn Athletic and Cycling Meeting at 2.30 p.m.

New Hairdressing Saloons and American Toilet Club, Crystal Palace
(Near Big Clock and Crystal Fountain).

Efficient staff of English Hairdressers, Continental Coiffeurs, and American Tonsors.

Special Rooms for Ladies' Hairdressing, and all the arrangements are on the most modern and improved system. In the Saloons will be found every Toilet Requisite, together with a choice selection of Brushes, Combs, Mirrors, Hand-glasses, and all the New French Perfumes and Cosmetics. Hats Ironed. Manicure and Chiropody. Open Ten till Eight.

The Talk of London is the Value they give at
J. SIMMONS & Co.
Complete House Furnishers,
230 & 232, Westminster Bridge Rd.

Before purchasing elsewhere, inspect their stock of Dining, Drawing, and Bedroom Suites, Bedsteads, Bedding, Carpets, Fenders, Fire Brasses, Lamps, China, Glass, Electro-plate, &c.

Immense Quantity of well-seasoned Cork Linoletum at 1s. 2½d. square yard.

A great variety of Useful Presents.

The London & Provincial Steam Laundry Company
(LIMITED).

Affiliated to the Army & Navy & Civil Service Co-operative Societies.

South-Eastern Branch: **FIRST-CLASS** 
GREEN LANE, PENGE, S.E. LAUNDRY WORK.

Price Lists can be obtained on application to the Secretary.

TO LET

TO LET

FOR ADVERTISING SPACES APPLY—

GUY WHITTEM & Co., Printers & Advertising Contractors,
Crystal Palace, S.E.

Telephone—202 Sydenham

1/8

TAKE A PACKET HOME WITH YOU.

1/8

AGENTS EVERYWHERE.

LYONS' TEA

VANS DELIVER DAILY IN LONDON.

1/8

May be had at all the Bars and Refreshment
Rooms throughout the Crystal Palace.

1/8

IND, COOPE & Co., (LIMITED), *Brewers, Importers, and Bonders* WINES & SPIRITS BURTON-ON-TRENT.

Contractors to His Majesty's Forces at Home and Abroad.
MESSES, CANTEENS, AND SHIPS SUPPLIED.

Prices, Terms, &c., on application to the

BREWERY & HEAD OFFICES,
Burton-on-Trent.